

- Circular LED Uplight
- Aluminium body machined from solid in 6082 alloy with surface protection treatment and subsequent polyester powder paint resistant to corrosion, atmospheric conditions and salt spray
- Thermal shock resistant tempered, extraclear, anti-glare safety glass with grinded edges
- Plastic cable gland resistant to corrosion, atmospheric conditions and salt spray
- Silicone gaskets
- IP67 external power supply included
- IP68 connector for the connection between projector and power supply included
- IP68 male ad female connectors and neoprene cable for connection extension (between projector and power supply) accessories available on request
- Housing for installation included
- No visible screws
- One-step installation without the need to open the fixture
- Maximum permissible ambient temperature +50°C for the 10W, 14W and 19W versions, +40°C for the 25W version

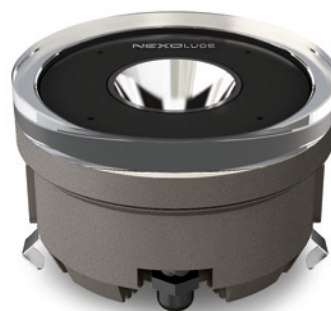

- *Proiettore LED circolare a pozzetto*
- *Corpo in alluminio tornito dal pieno lega 6082 con trattamento superficiale di protezione e successiva verniciatura in polvere di poliestere resistente agli agenti atmosferici, alla corrosione ed alle nebbie saline*
- *Vetro di sicurezza temperato con bordi molati, extrachiaro ed antiriflesso resistente agli shock termici*
- *Pressacavo in plastica resistente agli agenti atmosferici, alla corrosione ed alle nebbie saline*
- *Guarnizioni in silicone*
- *Alimentatore esterno IP67 incluso*
- *Connettore IP68 per la connessione fra proiettore ed alimentatore incluso*
- *Connettori IP68 maschio e femmina e cavo in neoprene per prolunga connessione (fra proiettore ed alimentatore) accessori disponibili su richiesta*
- *Controcassa per installazione inclusa*
- *Senza viti visibili*
- *Installazione in un'unica fase senza la necessità di aprire l'apparecchiatura*
- *Temperatura ambiente massima ammissibile +50°C per le versioni da 10W, 14W e 19W, +40°C per la versione da 25W*

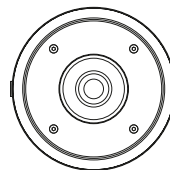
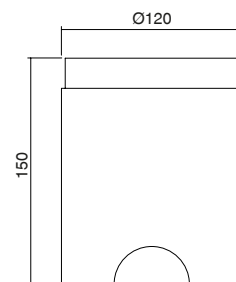
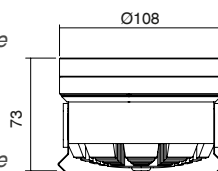

HOUSING/ CONTROCASSA



Lamp / Lampada 1 LED COB CREE	Input / Alimentazione 220/240V 50/60Hz	Power / Potenza 10 / 14 / 19 / 25W	Color Tolerance/ Tolleranza Cromatica 2-SDCM / 3-SDCM
-------------------------------------	--	--	---

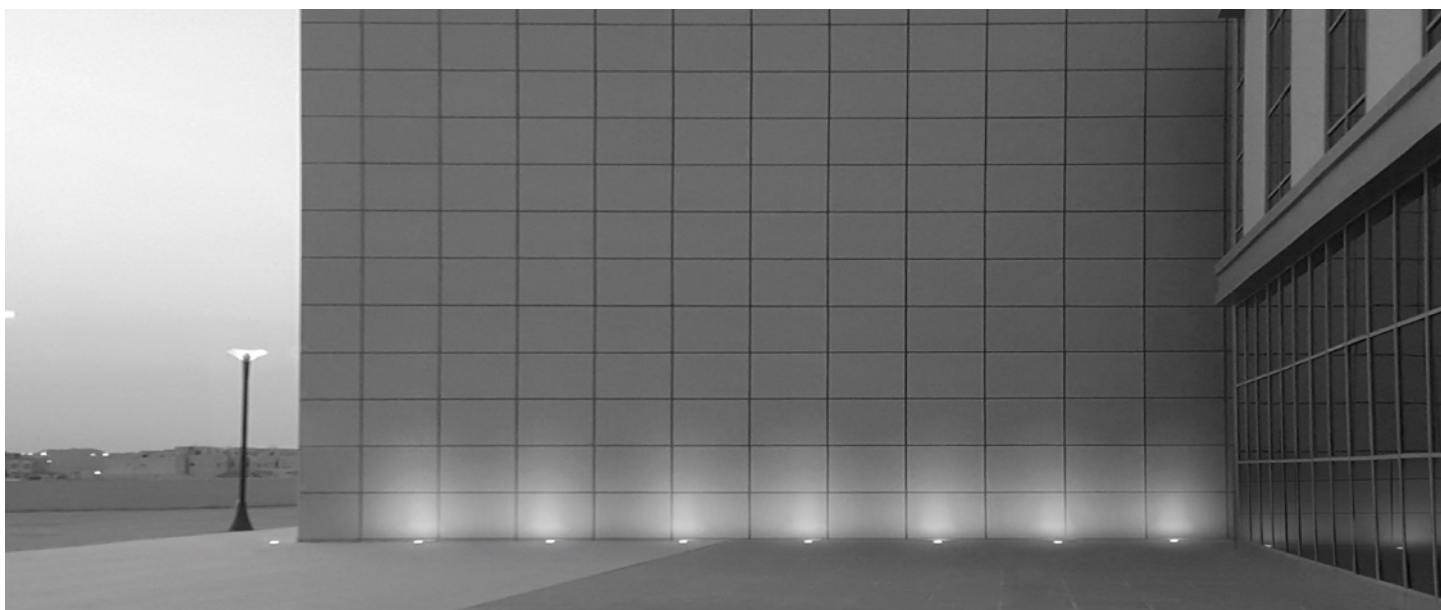

NEXO LUCE (Factory)
Strada Mirabella, 10
46040 Cavriana (MN), ITALY
T +39 0376 771513 F +39 0376 772235
sales@nexoluce.com www.nexoluce.com

Made in Italy

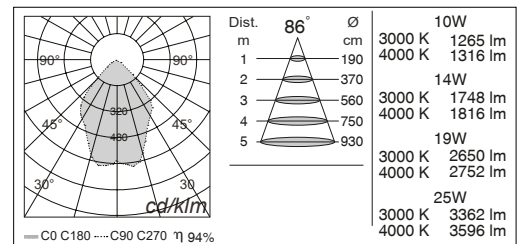
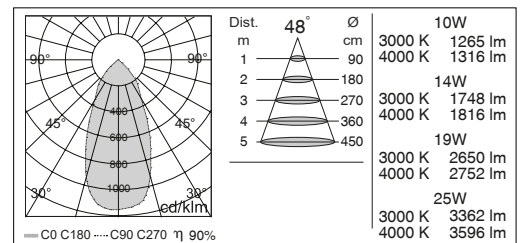
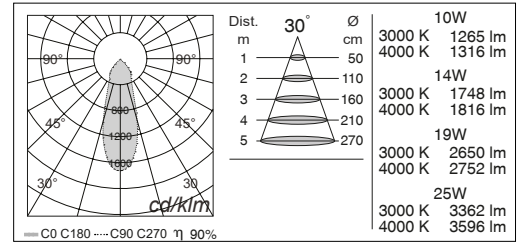
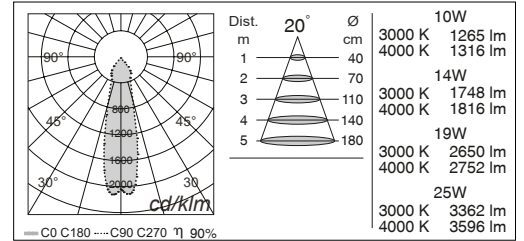
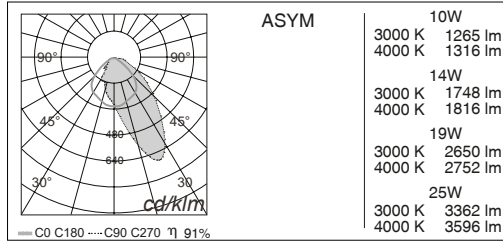
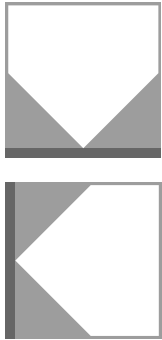

*IP68 CONNECTORS ON REQUEST
*CONNETTORI IP68 SU RICHIESTA
code: 003.0223.0



*2x0.35 H05RN-F CABLE (1 meter) ON REQUEST
*CAVO 2X0.35 H05RN-F (1 metro) SU RICHIESTA
code: 003.0224.0



Finishing
GLASS / VETRO

This luminaire contains built-in LED lamps.

The lamps cannot be changed in the luminaire.

LED

A++
A+
A
B
C
D
E

NEXOLUCE 874/2012

MAIN CODE CODICE BASE	RELEASE EDIZIONE	LIGHT COLOR COLORE LUCE	WATT WATT	OPTIC OTTICA	CONTROL CONTROLLO	FRAME COLOR COLORE
2607	.1	B 3000K	.10 10W	.D 20°	1 ON/OFF	.U GLASS / VETRO
		C 4000K	.14 14W	.F 30°	8 DIMMER 1-10V	
		* others on request / altri su richiesta	.19 19W	.I 48°		
			.25 25W	BZ 86°		
				CX ASYM 90°x45°		

CODE EXAMPLE : Projector with warm white light color at 3000K, 10W, 20° optic, ON/OFF control, glass finish
2607.1B.10.D1.U

ESEMPIO DI CODIFICA : Proiettore con luce calda a 3000K, 10W, ottica 20°, controllo ON/OFF, finitura in vetro
2607.1B.10.D1.U

NEXO LUCE (Factory)
Strada Mirabella, 10
46040 Cavriana (MN), ITALY
T +39 0376 771513 F +39 0376 772235
sales@nexoluce.com www.nexoluce.com

Made in Italy